

Plat of Survey

of

Unit 25 in Abbey Springs Condominium No. 1,

located in the Southwest 1/4 and the Southeast 1/4 of the Southeast 1/4 of Section 13, Town 1 North, Range 16 East, Village of Fontana-on-Geneva Lake, Walworth County, Wisconsin.

Surveyed for: **Pearce and Son, Inc.**
W7037 Brick Church Road
Walworth, Wisconsin. 53184

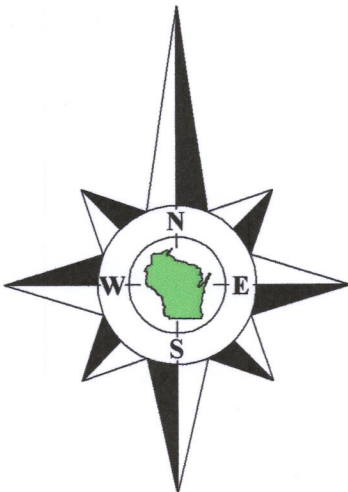

Bearings referenced to the East line of Units 25 and 26, recorded as S13°22'E on the plat of Abbey Springs Condominium No. 1.

Abbey Springs
Condominium No. 15

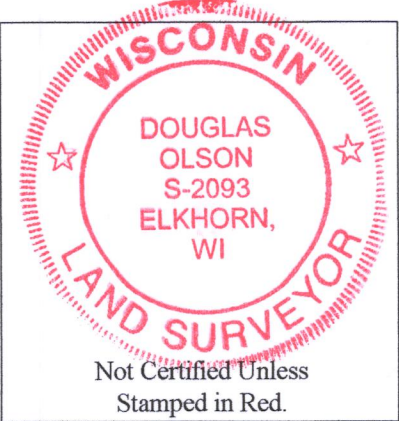

- Notes:**
- 1) This Plat of Survey is not certified unless signed and sealed in red ink.
 - 2) This survey is subject to Wisconsin lien laws. This Plat of Survey is the notice of intent to file lien. Lien waiver required.
 - 3) The Survey Date shown on this Plat of Survey is the completion date of the field work.

Copyright ©2019 by Olson Land Surveying, LLC.

All rights reserved. No part of this survey plat may be reproduced or transmitted in any form by any means - graphic, electronic, or mechanical, including photocopying, tracing, or information storage and retrieval systems - without permission in writing from Douglas G. Olson, Olson Land Surveying, LLC.

I hereby certify that I have surveyed the above described property in compliance with Chapter A-E 7 of the Wisconsin Administrative Code and that the map hereon is correct to the best of my professional knowledge and belief and shows the size and location of the property, its exterior boundaries, the location and dimensions of all visible structures thereon, boundary fences, apparent easements and roadways and visible encroachments, if any.

This survey is made for the exclusive use of the present owners of the property, and also those who purchase, mortgage or guarantee title thereto, within one year from the date hereof.

Douglas G. Olson
Wisconsin Professional Land Surveyor - 2093

Survey Date: September 12, 2019.
Revisions:

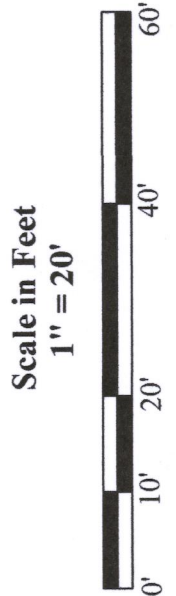

45 South Wisconsin Street | P.O. Box 322
Elkhorn, Wisconsin. 53121
Telephone: (262) 723-5454
Facsimile: (262) 723-8044
Email: doug@olsonsurveying.com
Website: www.olsonsurveying.com

OLSON
LAND SURVEYING, LLC
Rural | Residential | Commercial

Legend of Symbols & Abbreviations

Found Iron Pipe	N	North
Found Iron Rod	S	South
Recorded Information	E	East
Utility Box or Pedestal	W	West
Manhole	In	In
Water Valve	Deg	Degrees
Asphalt Surface	Sec	Seconds
Concrete Surface	Dist	Distances

Sheet 1 of 1 Sheets
Drawing Name:
Job Reference Number
2019.116

2019.116

ScdB-25 005-3507